

IMIC-6 Series

Dual Channel True Diversity
Wireless Microphone

A series of overlapping, wavy, light blue lines that flow across the lower half of the page, creating a sense of motion and sound waves.

Quick guide

IMIC-6 Receiver

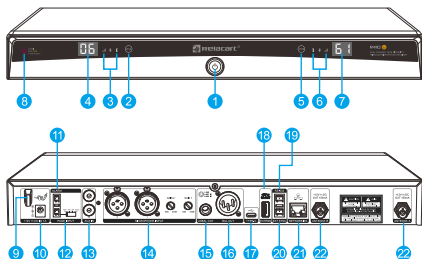

- | | |
|-------------------------------|---------------------------------------------|
| ① Power switch | ⑫ Public Address input port and control |
| ② CHA touch button | ⑬ Auxiliary input port |
| ③ CHA status indication | ⑭ 2-channel microphone input port |
| ④ Charging dock unlock switch | (gain adjustable) |
| ⑤ CHB touch button | ⑮ Audio output (6.3mm) |
| ⑥ ChB status indication | ⑯ Audio output (XLR) |
| ⑦ ChB display screen | ⑰ USB interface |
| ⑧ IR synchronization window | ⑱ Connect charging dock (USB-A) |
| ⑨ Power cord fixing ear | ⑲ RS 232 interface |
| ⑩ DC power input socket | ⑳ Infrared extension synchronizer interface |
| ⑪ Alarm input port | ㉑ Network port |
| | Dante port (model: IMIC-6D) |
| | ㉒ Antenna input (BNC) |

11 Alarm input port



ALARM (Alarm Input)

1. Mute at high level ($>0.6V \sim 12V \text{ MAX}$)
2. GND - Logic Ground

PAGE

3. GND - Audio Ground
4. 0-100V voltage audio input

12 Public Address input port and control

19 RS 232 interface

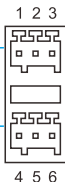

RS-232

1. TX
2. RX
3. GND

EXTERNAL SYNC

4. A
5. B
6. GND

20 Infrared extension synchronizer interface

T-6 Wireless Mini Microphone

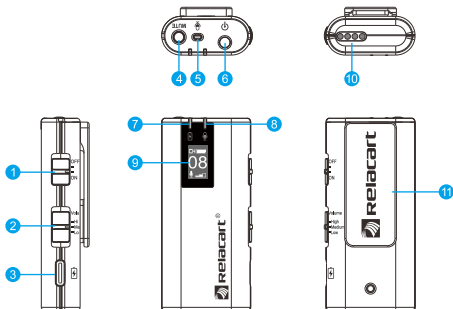

- | | |
|-------------------------|---------------------------|
| ① Power switch | ⑦ Power status indication |
| ② Gain control switch | ⑧ Audio input indication |
| ③ Charging port (DC 5V) | ⑨ Display |
| ④ Mute button | ⑩ Charging contact |
| ⑤ Built-in microphone | ⑪ Magnetic soft clamp |
| ⑥ Audio Input Port | |

WL-6 Laser page turning pen (Optional)

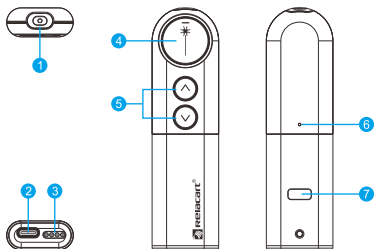

- | | |
|-------------------------|-----------------------|
| ① Laser head | ⑤ Page turning key |
| ② Charging port (DC 5V) | ⑥ Reset button |
| ③ Charging contact | ⑦ Magnetic soft clamp |
| ④ Laser emission button | |

EC series Single Bay Charger(Optional)

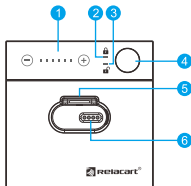

(EC-6)

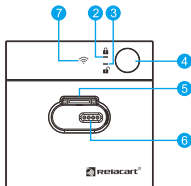

(EC-6W)

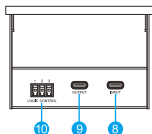

- ① Volume control button
- ② Lock indicator light
- ③ Unlock indicator light
- ④ Charging unlock switch
- ⑤ Charging compartment
- ⑥ Charging contact
- ⑦ Laser pen signal indicator light

- ⑧ Charging input port
- ⑨ Charging output port
- ⑩ Logic control port

- 1. Low level unlock (<0.3V)
Effective transition from high level to low level
- 2. No connection
- 3. Grounding

BNC antenna installation

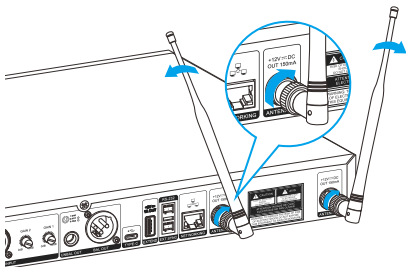
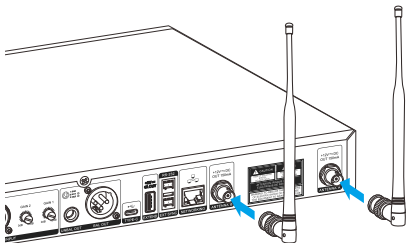

Connect the power adapter

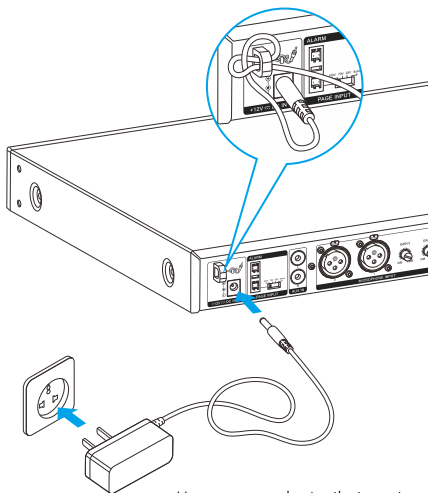

Use a power adapter that meets local regulatory requirements

Connect audio output

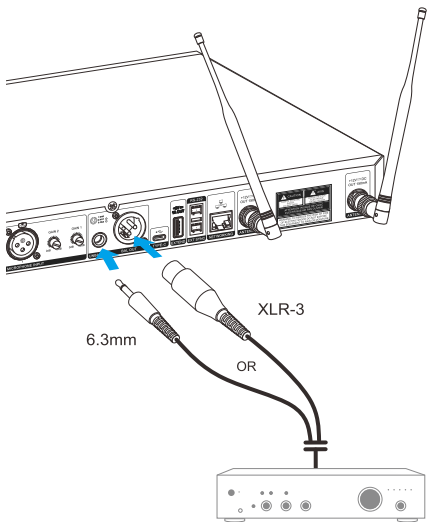

Connect audio input

Independent gain adjustment

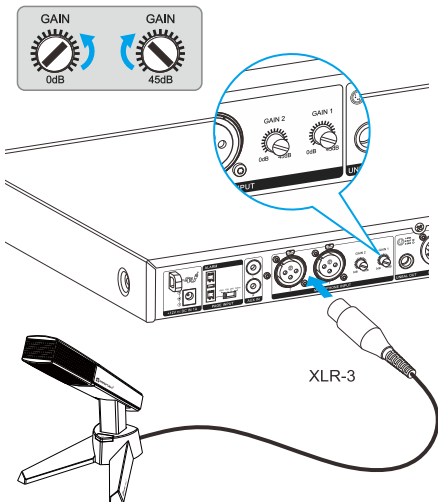

(Turn on or off 48V phantom power supply through software)

Connect the infrared extension synchronizer (Optional)

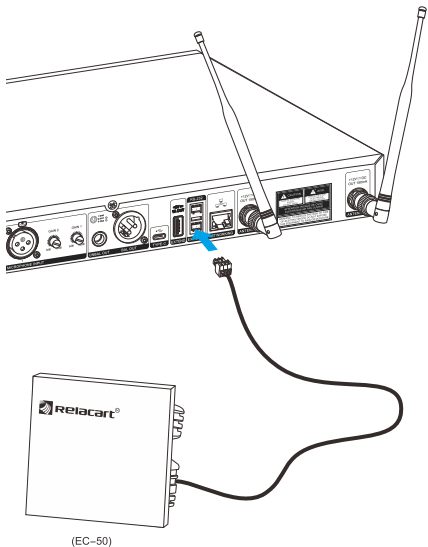

Charging dock connection and use

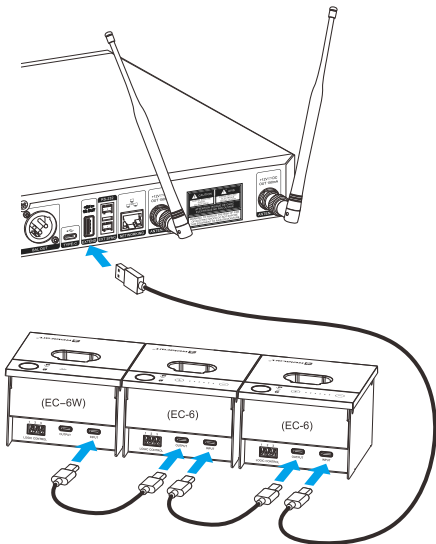

Up to 3 charging docks can be cascaded

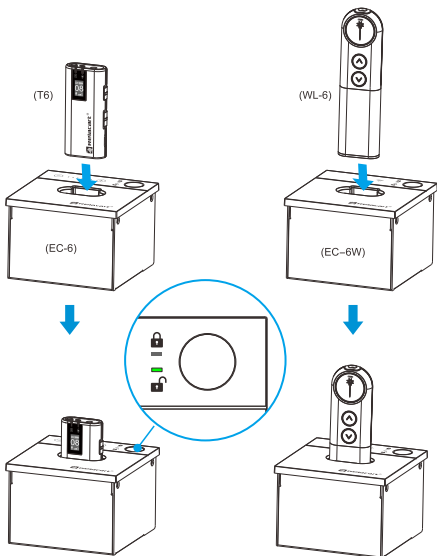

When the device is placed in the charging compartment, it automatically locks and can be unlocked by pressing the button.

The corresponding white indicator light is on when unlocking/locking

ON/OFF

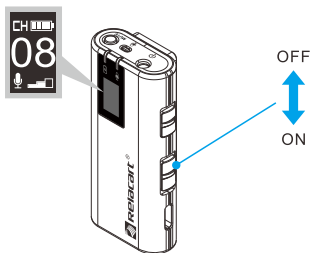
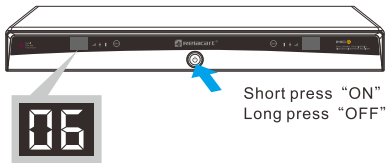

Channel settings

Touch the corresponding channel button to enter the working channel and change settings.



i Enter the channel menu

Long press for 3 seconds



Flashing

ii Adjust channel

Long press



Flashing

Confirm the setting after 3 seconds and enter infrared frequency pairing mode. If the receiver is connected to a charging dock, the microphone will automatically bind when placed in the charging dock.

SYNC synchronization for frequency pairing

After the channel is set, if there is no operation for 3 seconds, the corresponding channel screen will display "SY" to indicate that it has entered the infrared frequency pairing mode.

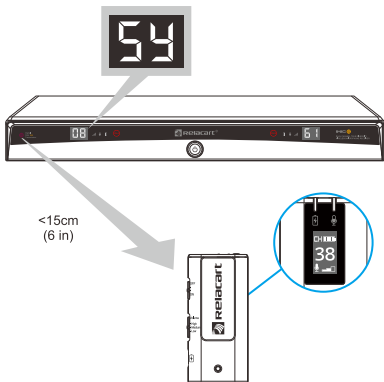

Attention: When using iR infrared frequency pairing, the miniature microphone must be aimed directly at the receiver, otherwise it will affect the frequency pairing function.

If you use an infrared expansion synchronizer, you only need to connect the receiver to the EC-50 infrared expansion synchronizer, and then align the transmitter with the EC-50 panel within a range of about 100cm to automatically complete the frequency synchronization. When the frequency synchronization is completed, the panel will make a "beep" sound to prompt completion.

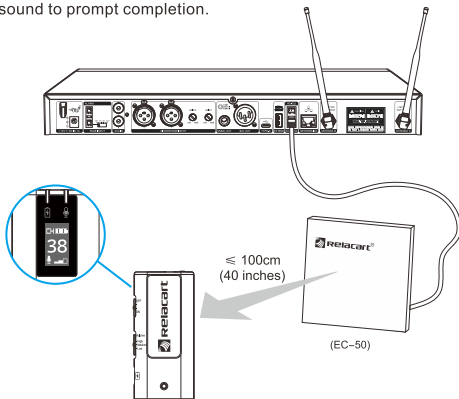

Note: When iR infrared frequency pairing, the microphone must be aimed directly at the EC-50 panel, otherwise the frequency pairing function will be affected.

i Successful frequency pairing

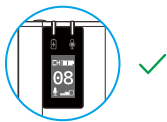
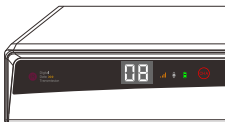

Both the receiver and transmitter display the same channel, and the corresponding receiver status indicator lights up.

ii Frequency pairing failure

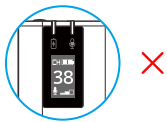
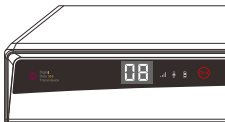

The receiver and transmitter both display different channels, and the corresponding status indicator light of the receiver is not on. Please try the channel setting operation again.

*The function menu automatically exits after frequency pairing timeout or success

Audio status

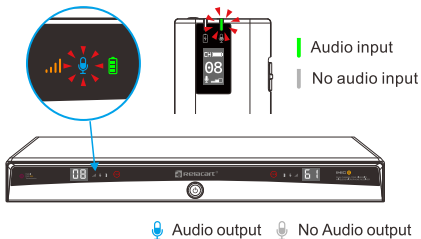

Mute mode

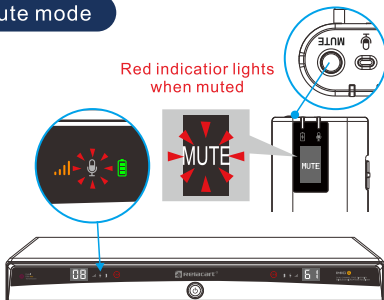

Battery status

Low battery
(Red indicator flashing)

Electricity level meets
(extinguished)

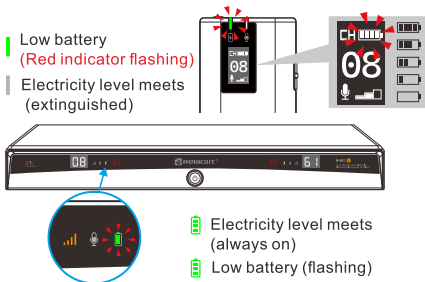

Mic Gain

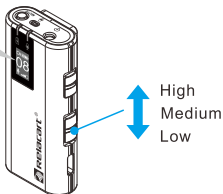
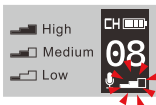

Installation of windproof fur bracket

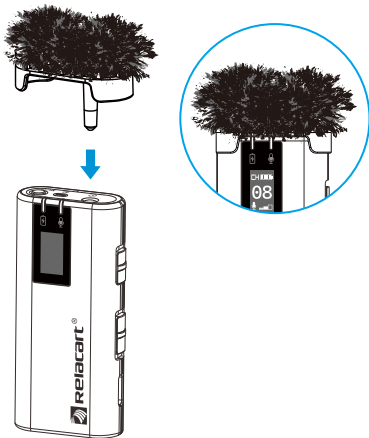

Wearing method

Standard wearing

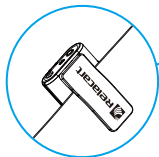
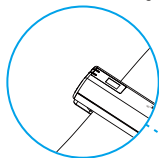

Hidden wearing

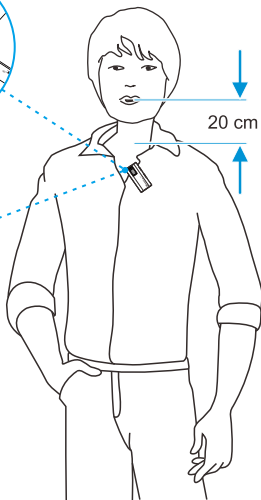

Technical Parameter

IMIC-6 Dual Channel Receiver

Receiving Frequency Range:	470MHz-960MHz
Receiving Method:	Superheterodyne
Image Rejection:	45dBm
RF Sensitivity:	When inputting 10dBu, S/N \geq 45dB
Squelch adjustment:	Built-in setting parameters
Frequency synchronization method:	Manual button setting
Digital Audio Output:	Supports Type-C, USB audio, RJ45, DANTE audio
Power Supply Mode:	DC12V 1A
Dimensions (mm):	410 (W) \times 206 (D) \times 43 (H)
Net Weight:	1.9kg

T6 Mini Wireless Microphone

Carrier Frequency Range:	470MHz-960MHz
Oscillation Mode:	PLL frequency synthesis
Transmit Power:	13.5dBm
Carrier Error:	0.005%
Harmonic Radiation:	-32dBm
Modulation Method:	FM
Max. Deviation:	\pm 65KHz
Max. Input Level:	25mV
Frequency Setting:	Auto/Infrared
Power Supply Mode:	Built-in 3.7V 435mA lithium battery power supply
Normal Working Current:	100mA
Max. Charging Current:	300mA
Battery Life:	\geq 4 hours
Dimensions (mm):	32(W) \times 16.5(D) \times 67(H)
Net Weight:	31.5g



www.relacart.com

Online Manual

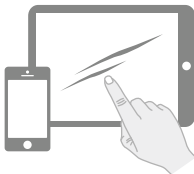

www.relacart.com/downloads

🔍 IMIC-6_



 @relacart

 @relacart

 @relacart

Relacart Electronics Co., LTD.

1302, South tower world trade centre complex,
371-375 Huanshi Dong Road, Guangzhou